

FIRST FLOOR PLAN

**NOTES:**

- 1.) WINDOWS SIZES IN SLEEPING ROOMS ARE DESIGNED TO BE THE LIFT OUT (REMOVABLE) TYPE UNITS WHICH COMPLY WITH SECTION R 310.2 EMERGENCY EGRESS OF THE 1995 CABO ONE AND TWO FAMILY DWELLING CODE.
- 2.) ALL INTERIOR PARTITIONS ARE 4" WIDE UNLESS OTHERWISE NOTED.
- 3.) FIREPLACE & HEARTH TO BE CONSTRUCTED IN COMPLIANCE WITH LOCAL BUILDING CODE. SIZE TO BE DETERMINED BY OWNER.
- 4.) OLD VIRGINIA HAND HEWN LOG HOMES, INC. ASSUMES NO RESPONSIBILITY FOR ANY CHANGES TO THIS PLAN UNLESS SUBMITTED TO THIS OFFICE IN WRITING.
- 5.) ALL EXTERIOR WINDOWS AND DOORS ARE DESIGNED FOR 1" x 6" TRIM.

**CAUTION !!!!!**

DO NOT USE DIMENSIONS ON THIS PAGE FOR FOUNDATION! REFER TO FOUNDATION SHEET FOR FOUNDATION DIMENSIONS AND ABIDE BY ALL THAT IS NOTED.  
CHECK WITH LOCAL BUILDING CODES BEFORE STARTING CONSTRUCTION.



*Old Virginia Hand Hewn Log Homes, Inc.*

Route 2, Box 455A  
Pennington Gap, VA 24277  
(540) 546-5647

SCALE: 1/4"=1'-0"	DRAWN BY: JDR	APPRVD:
DATE: 9-3-99	REV:	
PLAN FOR:		
<b>FIRST FLOOR PLAN</b>		
<b>CUMBERLAND GAP</b>		SHEET <b>4 of 8</b>

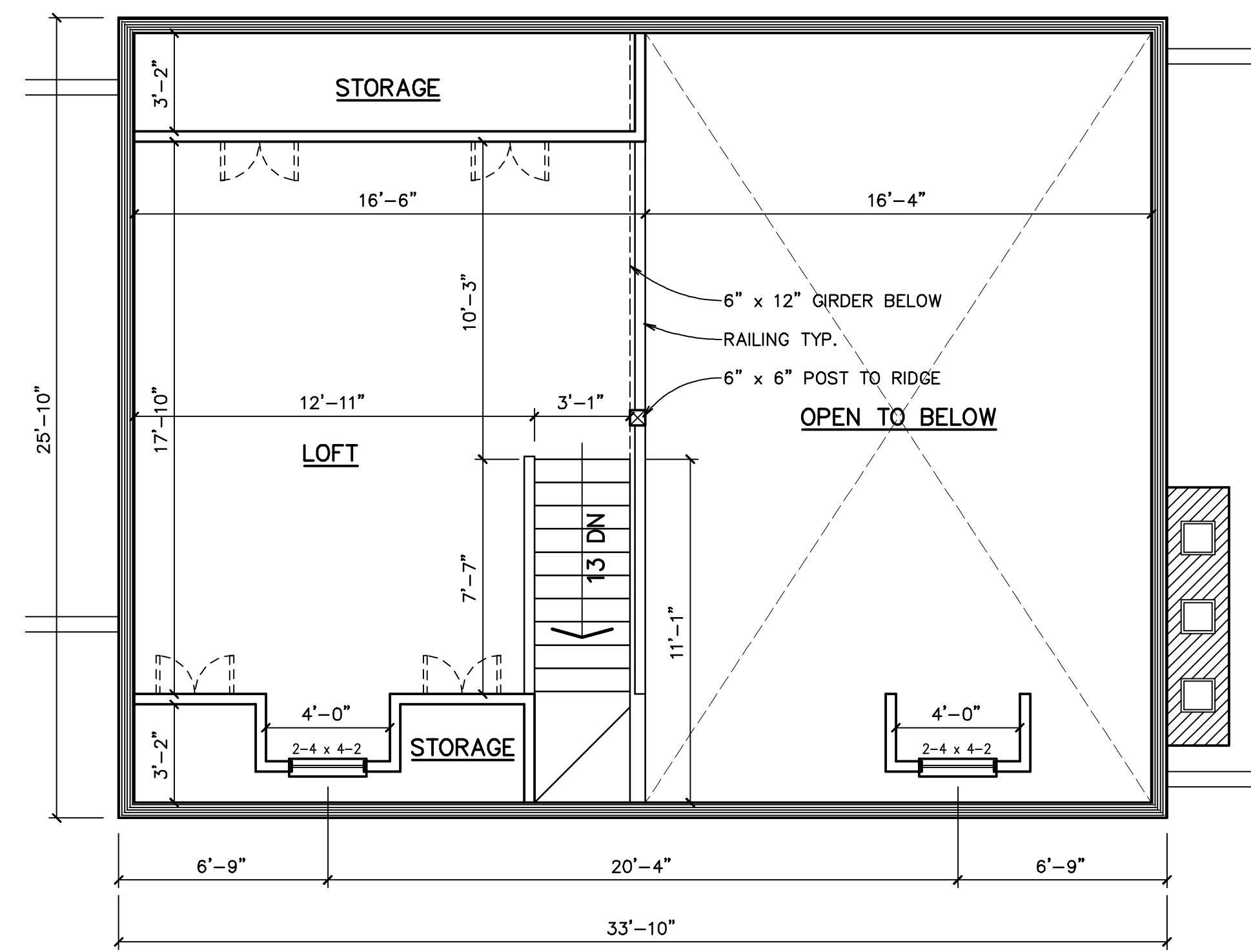

SECOND FLOOR PLAN

NOTES:

- 1.) WINDOWS SIZES IN SLEEPING ROOMS ARE DESIGNED TO BE THE LIFT OUT (REMOVABLE) TYPE UNITS WHICH COMPLY WITH SECTION R 310.2 EMERGENCY EGRESS OF THE 1995 CABO ONE AND TWO FAMILY DWELLING CODE.
- 2.) ALL INTERIOR PARTITIONS ARE 4" WIDE UNLESS OTHERWISE NOTED.
- 3.) FIREPLACE & HEARTH TO BE CONSTRUCTED IN COMPLIANCE WITH LOCAL BUILDING CODE. SIZE TO BE DETERMINED BY OWNER.
- 4.) OLD VIRGINIA HAND HEWN LOG HOMES, INC. ASSUMES NO RESPONSIBILITY FOR ANY CHANGES TO THIS PLAN UNLESS SUBMITTED TO THIS OFFICE IN WRITING.
- 5.) ALL EXTERIOR WINDOWS AND DOORS ARE DESIGNED FOR 1" x 6" TRIM.

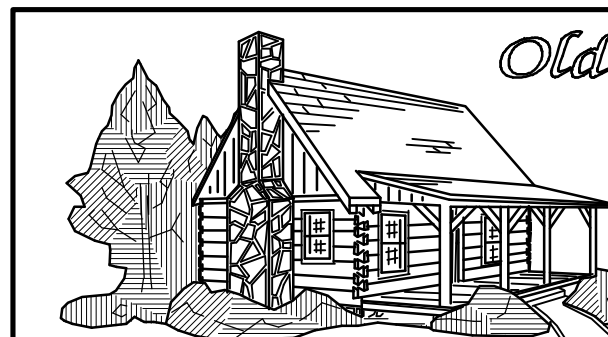

Old Virginia Hand Hewn Log Homes, Inc.

Route 2, Box 455A  
 Pennington Gap, VA 24277  
 (540) 546-5647

SCALE: 1/4"=1'-0"	DRAWN BY: JDR	APPRVD:
DATE: 9-3-99	REV:	
PLAN FOR:		
SECOND FLOOR PLAN		
CUMBERLAND GAP		SHEET 5 of 8